

Houston Ship  
Channel



**PORT HOUSTON™**

PROPERTY FOR LEASE  
111 East Loop N, Houston, TX 77029

**±70.85 Acres**  
165,730 SF OF BUILDINGS



**PORT HOUSTON™**

[porthouston.com/real-estate](http://porthouston.com/real-estate)

For more information on properties and rates, contact us at:

**713-670-2400**

[realestate@porthouston.com](mailto:realestate@porthouston.com)





PORT HOUSTON

## PropertyDetails

TURNING BASIN TERMINAL

The property is comprised primarily of 12 buildings and  $\pm 65$  Acres paved yard

### Details

- Building 1 | 13,980 SF
- Building 2 | 20,870 SF
- Building 3 | 27,310 SF
- Building 4 | 12,180 SF
- Building 5 | 3,620 SF
- Building 6 | 390 SF
- Building 7 | 7,870 SF
- Building 8 | 2,490/2,370 SF
- Building 9 | 12,630 SF
- Building 10 | 7,390 SF
- Building 11 | 33,420 SF
- Building 12 | 9,750 SF
- Building 13 | 11,220 SF

### Features

- Water and Sewer by the Port Authority
- Extensive Electrical Distribution
- Overhead Cranes
- Preferential Berth Access
- Rail-served – 5 Rail spurs – Approx. 1,100 - 1,200 LF
- Rail service with PTR
- $\pm 1,000$  feet to Deepwater Dock
- Reduced Property Taxes
- Cross-Dock Throughput Requirements available on Request
- Foreign Trade Zone (FTZ) designation, #84 – **Ranked #1 FTZ in the U.S.**
- Available April 2024
- Contact Broker for Lease Terms

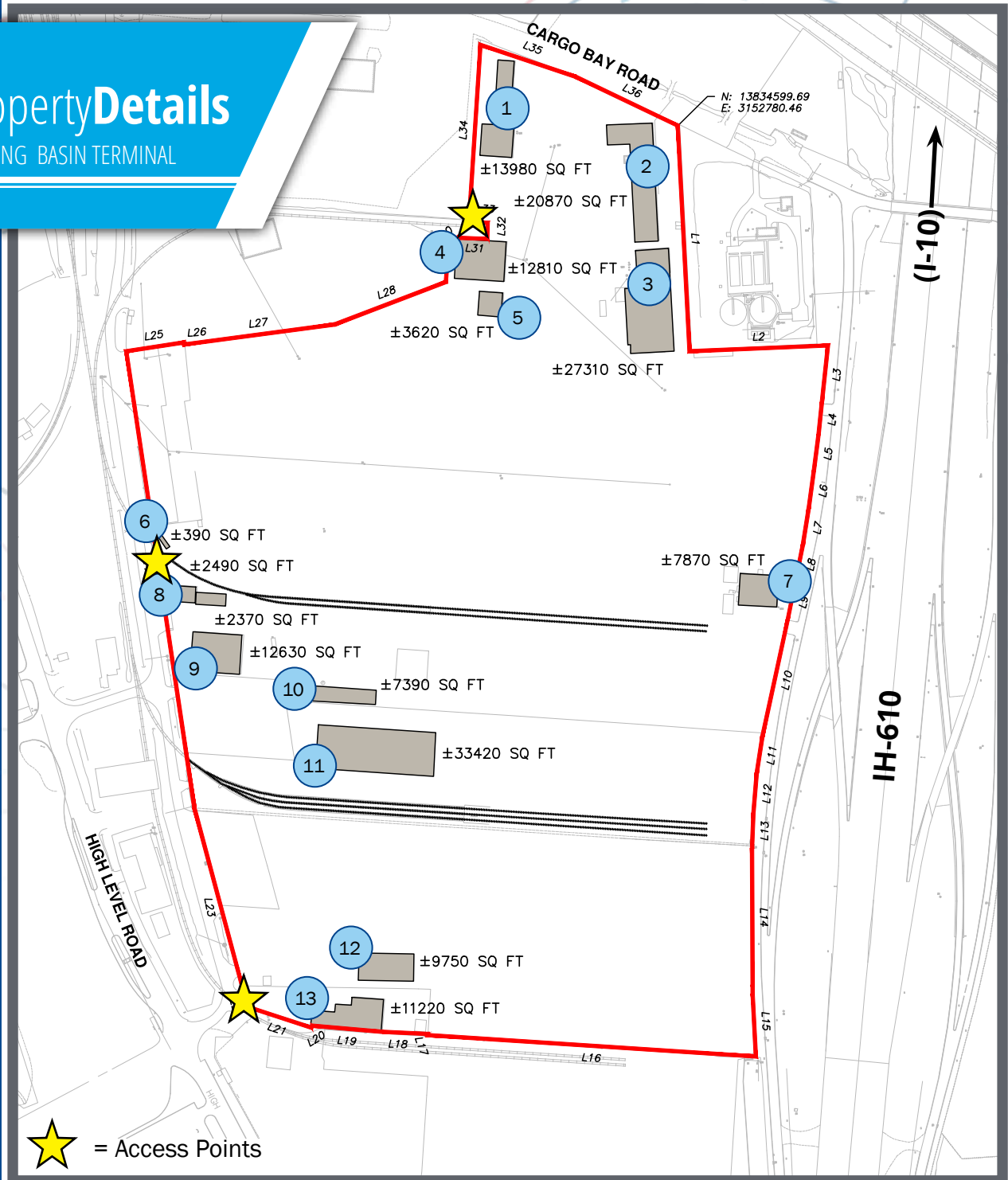



**PORT HOUSTON™**

## AreaData

TURNING BASIN TERMINAL

### DISTANCES

|                        |           |
|------------------------|-----------|
| NOLA                   | 349 miles |
| Dallas                 | 247 miles |
| Austin                 | 175 miles |
| IAH                    | 26 miles  |
| Bayport Terminal       | 24 miles  |
| Barbour's Cut Terminal | 19 miles  |
| CBD                    | 11 miles  |
| Hobby                  | 7 miles   |







PORT HOUSTON™

## BY The NUMBERS

**52**  
miles  
long

**200**  
public & private  
facilities alongside

**20K**  
ship movements  
annually

**200K**  
barge movements  
annually

**1.5**  
million  
jobs supported  
by Port activity

**\$439.2**  
billion  
of total  
economic value

**18.6%**  
of Texas  
GDP

**\$10.6**  
billion  
of state and  
local taxes



U.S. Port for  
Waterborne Tonnage



Container port  
on the Gulf of Mexico\*



Ranked U.S. port in terms of  
total foreign cargo value



Largest Texas port with 97%  
market share in container

\* #5 Container Port in the U.S.